

ACCESSORY

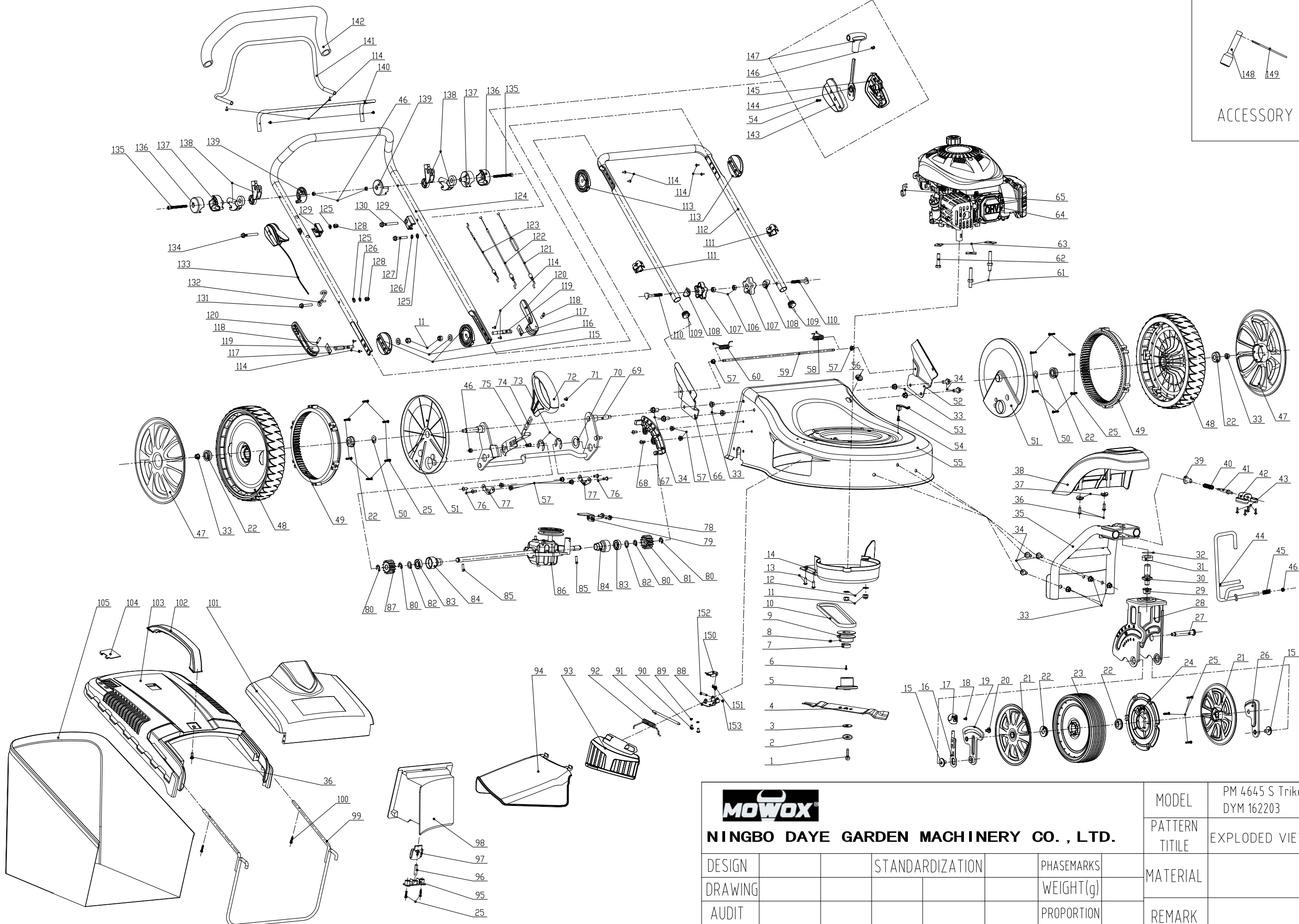

**MOWOX**  
**NINGBO DAYE GARDEN MACHINERY CO., LTD.**

MODEL PM 4645 S Trike/  
 DYM 162203  
 PATTERN TITLE EXPLODED VIEW

DESIGN		STANDARDIZATION	PHASEMARKS
DRAWING			WEIGHT(g)
AUDIT			PROPORTION
CRAFT		APPROVAL	MAPSHEET
		TOTAL PAGE	PAGE
			VERSION

MATERIAL  
 REMARK  
 DRAWING NO

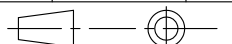

in sketch	part number	part description	Qty
1	A26800606201	balde locking bolt	1
2	2105300001C	dish washer	1
3	2105200245A	pressing plate of blade support	1
4	2105200263A	blade	1
5	2105200251A	stamping blade support	1
6	2105300079A	flat key	1
7	21021000020001A	blade support bush	1
8	A26800300502	locking screw	1
9	2102300109B	driven wheel	1
10	2102600036N	triangle belt	1
11	A26800500801	locking nut	4
12	A26800700701	flat washer	2
13	A26800103701	self-driving screw	2
14	21041001910001C	belt wheel protecting cover	1
15	2101300077A	Special socket head bolts	2
16	2106200863B	adjustment rod	1
17	21061002810001A	adjustment handle	1
18	A26800317301	sank screw	1
19	2101200033A	right wheel plate	1
20	2109300065A	Special-shaped screw	1
21	21011002190103A	wheel cover	2
22	2101300065A	bearing	6
23	21011002130001A	wheel assy	1
24	21041004330001A	decorative cover	1
25	A26800100501	self-driving screw	17
26	2101200034A	left wheel plate	1
27	2101300043N	front wheel axis	1
28	2101200031B	fixxed bracket for front wheel	1
29	A26800508101	locking nut	1
30	2101300008A	spindle	1
31	3061301001	deep groove ball bearing	1
32	3042301001	circlip for shaft	1
33	A26800502801	locking nut	9
34	A26800606401	bolt	7
35	21015000070001A	Stents welding assembly for front wheel	1
36	A26800104601A	self-driving screw	3
37	21061001113201N	Curvy gasket	2
38	21041006240001A	front cover for trike wheel	1
39	2109100002A	bearing sheath	1
40	2109800150A	spring for locating pin	1

in sketch	part number	part description	Qty
41	2101300082A	locating pin	1
42	2109400001A	permanent seat for spindle	1
43	A26800203201	tooth screw	4
44	2101300055A	Higher bracket	1
45	2106800549A	spring for Higher bracket	1
46	A26800500501	locking nut	4
47	21011001750103N	11"wheel cover	2
48	21011002610001A	wheel assy	2
49	2101100081B	wheel gear ring	2
50	A26800706202	wave washer	2
51	21011003730001F	11"dustproof wheel cover	2
52	21062001650001B	left handle bracket	1
53	21031000650001A	Chassis hang line hook	1
54	26800100302	self-driving screw	2
55	21062009990001A	deck	1
56	2106600013A	inhaul cable sheath	1
57	A26800502401	locking nut	8
58	2109800071A	left twist spring	1
59	2106300028B	long rod	1
60	2109800072A	right twist spring	1
61	2109300055A	special bolt	2
62	A26800601701	bolt	1
63	2103300032A	square gasket	3
64	60400111101	engine	1
65	2106200463A	throttle cable wire hook	1
66	21062001660001B	right handle bracket	1
67	21061002804017A	height adjustment board	1
68	A26800202001A	tooth screw	2
69	2101500008A	rear wheel axle ass'y	1
70	2109200020A	adjusting washer	1
71	A26800303301	sank screw	2
72	21061002880001A	height adjustment ass'y	1
73	A26800900301	open block ring	2
74	2106200815A	handle assy	1
75	A26800203001A	cross-pan screw	1
76	A26800201901	tooth screw	4
77	2106200128A	wheel axle fixed ring	2
78	A26800611201	bolt	2
79	2102200040A	position board	1
80	A26800900201	open block ring	4

in sketch	part number	part description	Qty
81	2104400013E	left output gear ass'y	1
82	A26800705102	flat washer	2
83	A26800402302	bearing	2
84	2102400152A	bearing sheath	2
85	A26809000102	round pin	2
86	2102300072A	gear box assy	1
87	2104400014E	right output gear ass'y	1
88	2103200228A	side-discharge fixing board	1
89	A26800800402	spring wahser	2
90	A26800201501	tooth screw	2
91	2106200053N	side-discharge position fixing shaft	1
92	2109800066D	side cover board spring	1
93	21061005340001A	side-discharge cover board	1
94	21041001313209C	side-discharge protecting cover	1
95	21041001160001A	knob pressing board	1
96	2109800022C	spring	1
97	21041001150001A	kit botton	1
98	21061000930001A	mulching kit	1
99	2107200043B	grass catcher bracket	1
100	A26800103202	self-driving screw	2
101	21041003303208B	rear cover board	1
102	21071000730001N	handle of grass catcher	1
103	21071000720001A	grass catcher cover	1
104	21071000080103A	level indicator	1
105	21077000462133A	grass bag	1
106	A26800502301A	nut	2
107	21061000020001B	lower handle knob	2
108	21061000113201A	curvy gasket	2
109	2106100003A	tube plug	2
110	A26800600401	flat head bolt	2
111	21061000013201A	cable clamp	2
112	21062001800001A	lower handle	1
113	21061003883201N	lower adjustment gear	2
114	A26800104902	self-driving screw	12
115	21061003843206D	upper adjustment gear	2
116	2109200029B	flat gasket	2
117	2109200025A	pressing plate	2
118	A26809004801A	round pin	2
119	2109300026A	locking handle bolt	2
120	21061000273201A	locking handle	2

in sketch	part number	part description	Qty
121	2106800252B	driving cord ass'y	1
122	2106800361A	flameout cord ass'y	1
123	2109800002A	lock cord assy	1
124	21062008060001B	upper handle	1
125	A26800700801	flat gasket	3
126	A26800800303	spring wahser	2
127	A26800612101	bolt	1
128	A26800501603A	lid nut	2
129	21061000043201A	Cable fixed block	2
130	A26800608201	bolt	1
131	A26800607701	bolt	1
132	2106300002A	Hang line hook	1
133	2106800435A	choke cord ass'y	1
134	A26800603601	bolt	1
135	A26800611401	screw	2
136	21061004573201N	outside positioned support	2
137	21061004593201N	inside positioned support	2
138	21061001803201B	self-propelled cord hanging block	4
139	21061001153206N	cover board of pulling pole support	2
140	21062001990104A	flameout rod	1
141	21062002080001A	driving rod	1
142	2106600017N	handle sheath	1
143	21041004350001A	right lock switch box	1
144	2106200880A	locking handle	1
145	21041004344052A	left lock switch box	1
146	A26800202501	tooth screw	1
147	21061001120001N	handle adjustment	1
148	2012200002A	socket spanner	1
149	2012100004A	socket spanner lever	1
150	2103200229A	locking block	1
151	2103800011A	torsional spring	1
152	2103300040A	stationary shaft	1
153	3043301003	split washer	1